

ADJUSTABLE BALLET RACK WITH TWO CROSSES ITEM#:PSBBCB2ADJ

REVISED ON 7/14/2016

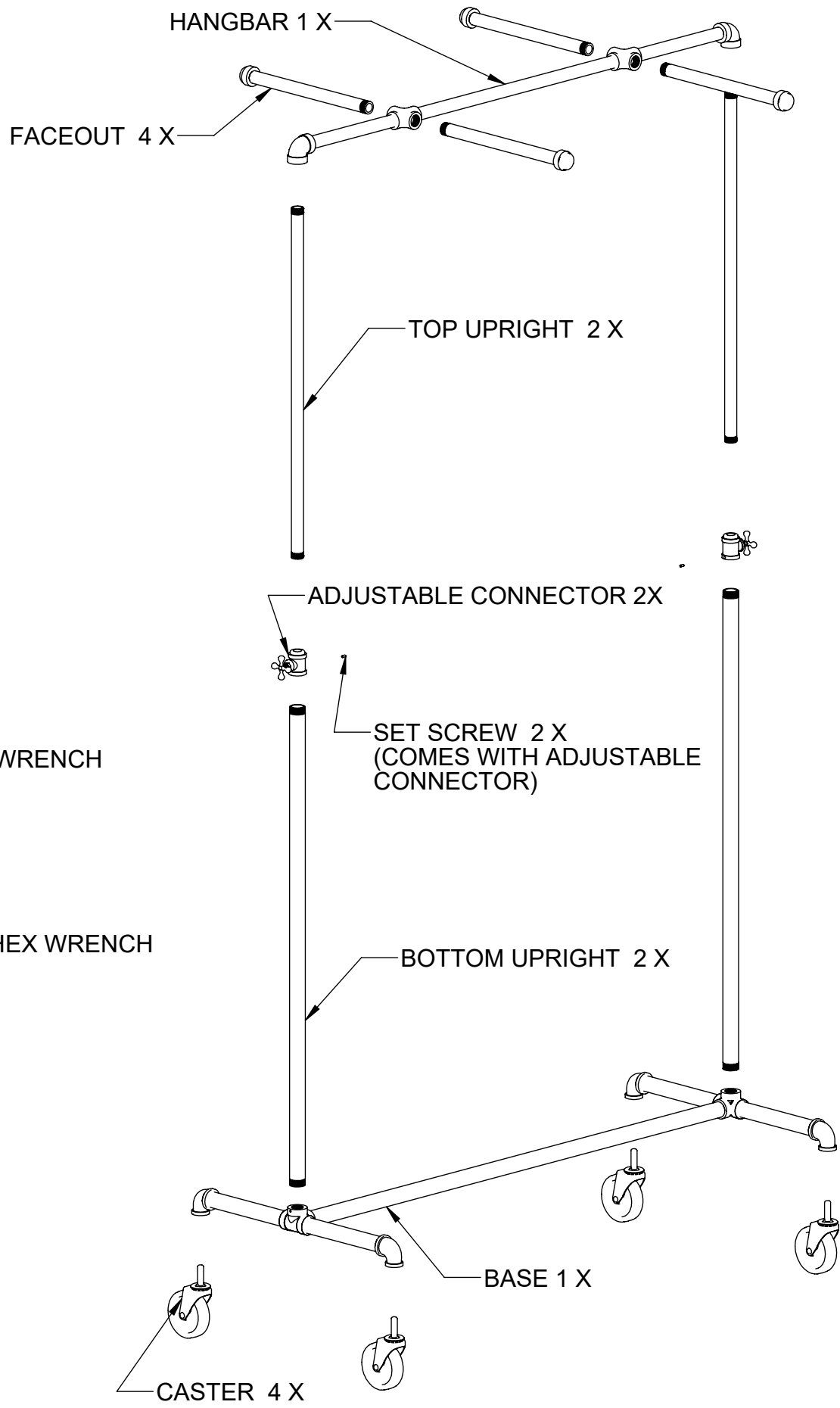

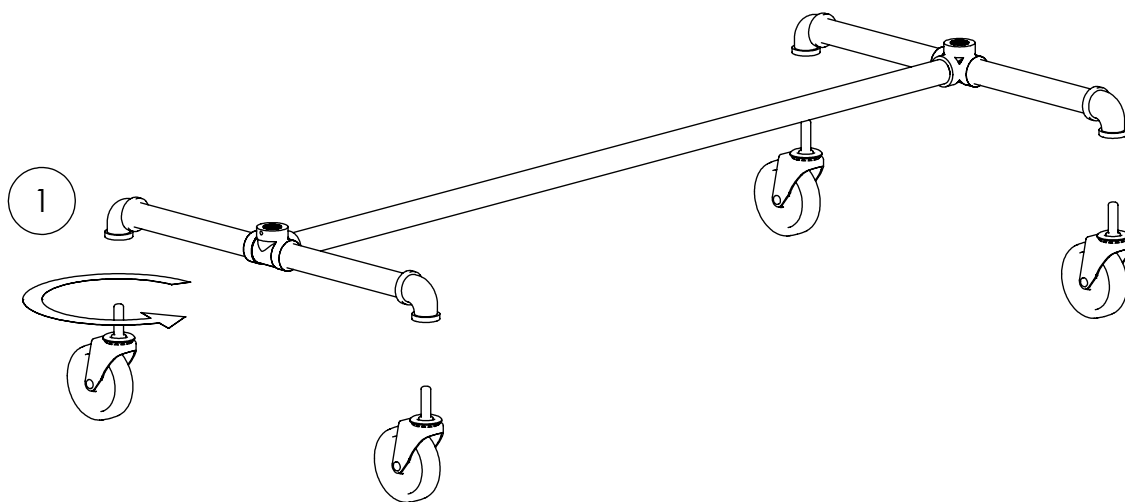

- 1 SCREW THE CASTERS INTO THE BASE AS SHOWN USING PROVIDED WRENCH

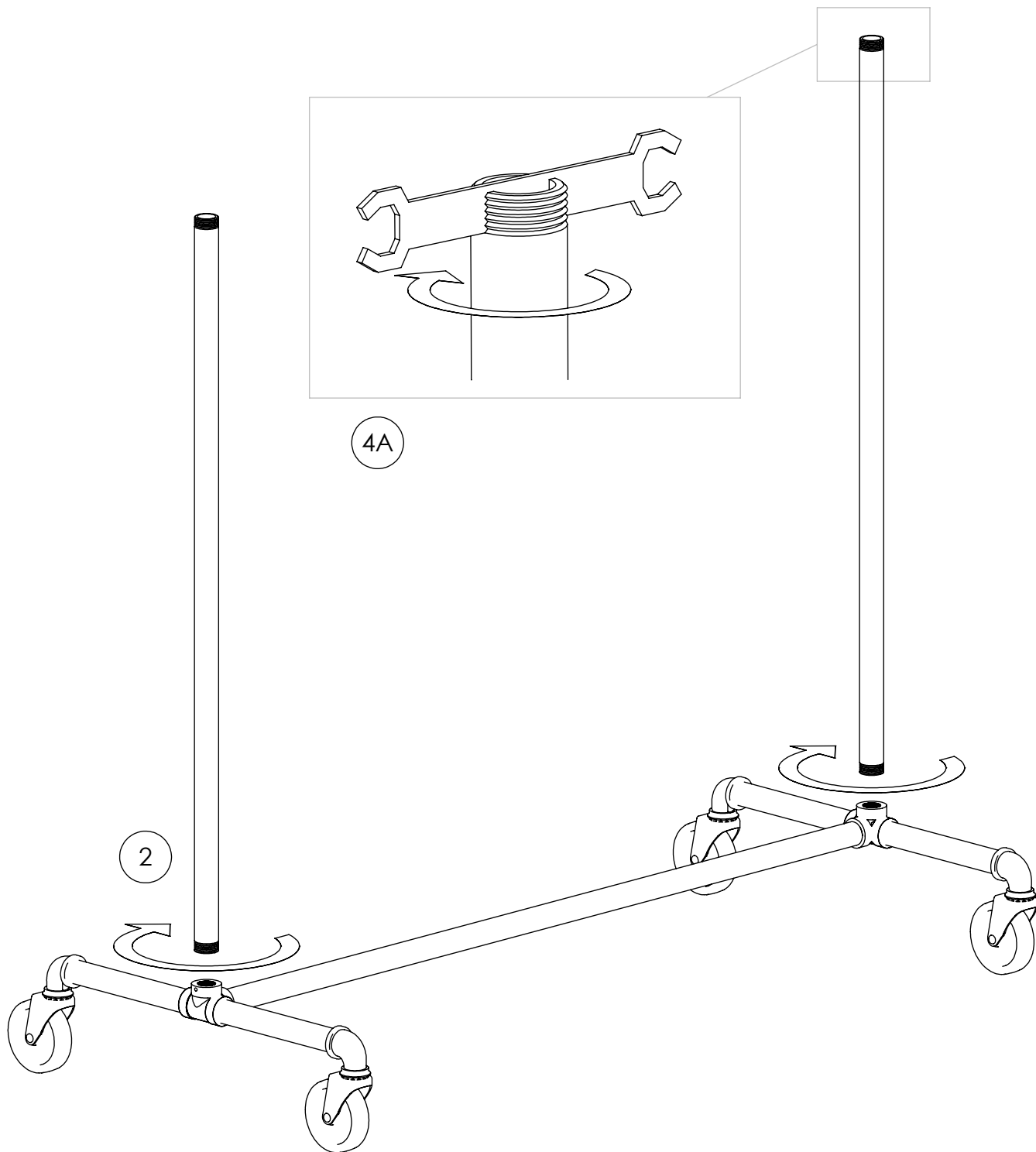

2 BY HAND, SCREW BOTTOM UPRIGHTS AS SHOWN

2A TO FULLY TIGHTEN UPRIGHT, PLACE INCLUDED WRENCH INTO PIPE SLOTS AS SHOWN. TIGHEN FULLY.

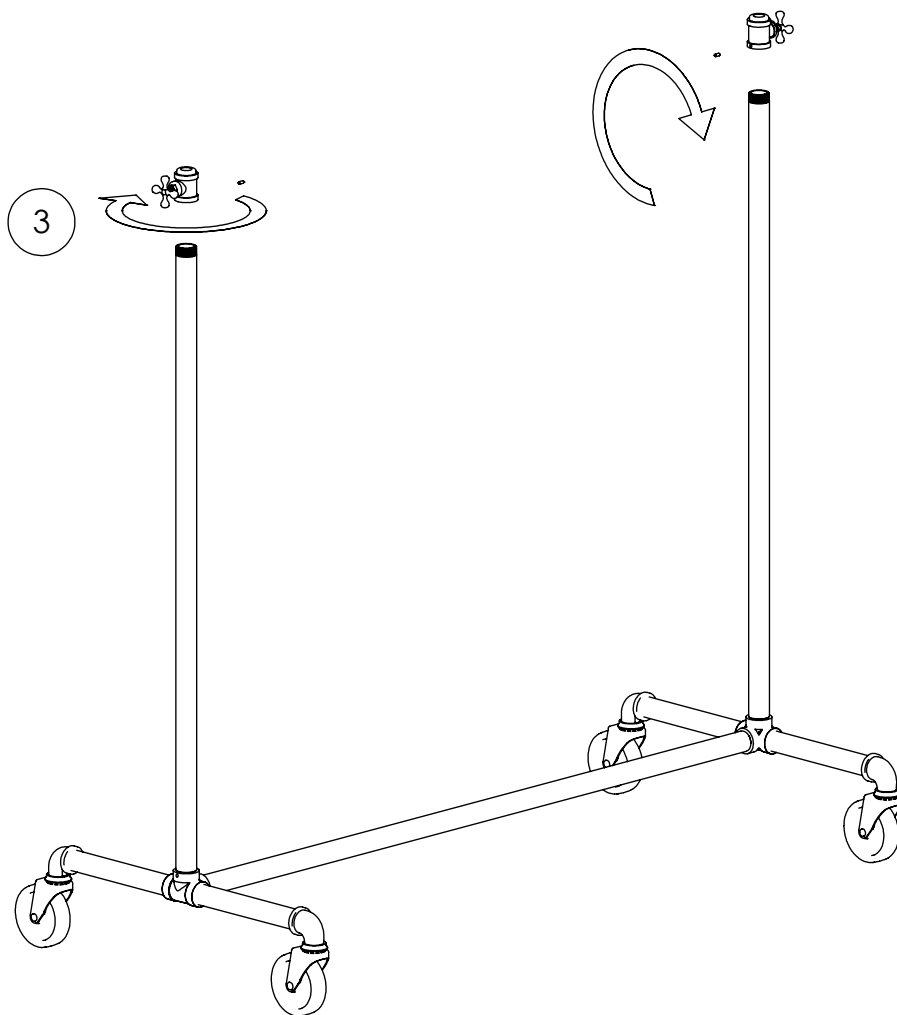

- 3 BY HAND, SCREW ADJUSTABLE CONNECTOR TO BOTTOM UPRIGHTS ALL THE WAY & THEN ADJUST SO THAT IT ALIGNS AS SHOWN BELOW
- 4 TIGHTEN SET SCREW USING HEX WRENCH TO LOCK ADJUSTABLE CONNECTOR IN PLACE.

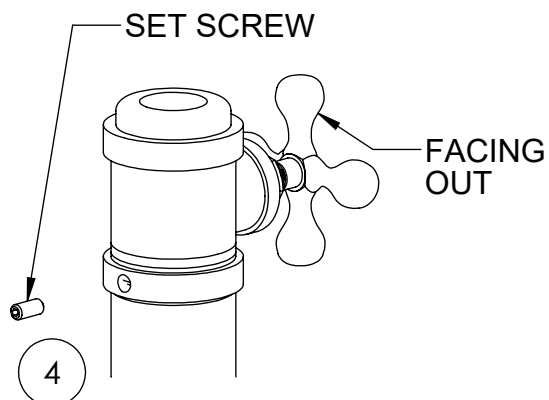
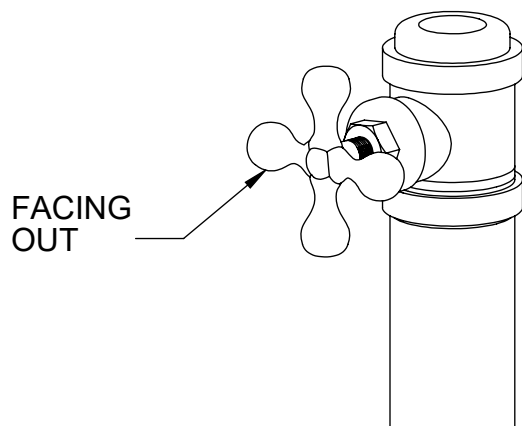

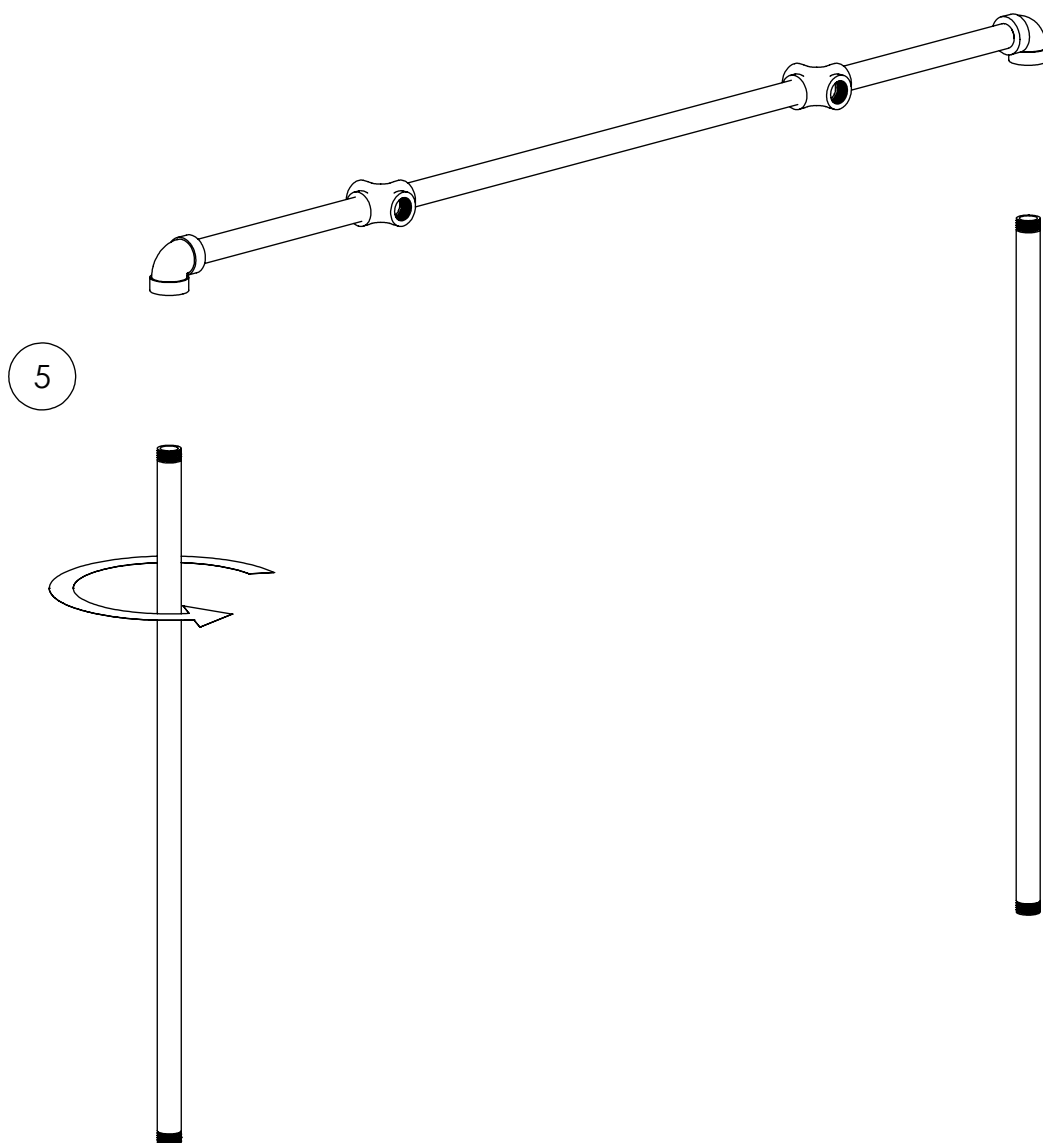

5 BY HAND, SCREW TOP UPRIGHTS TO HANGBAR AS SHOWN

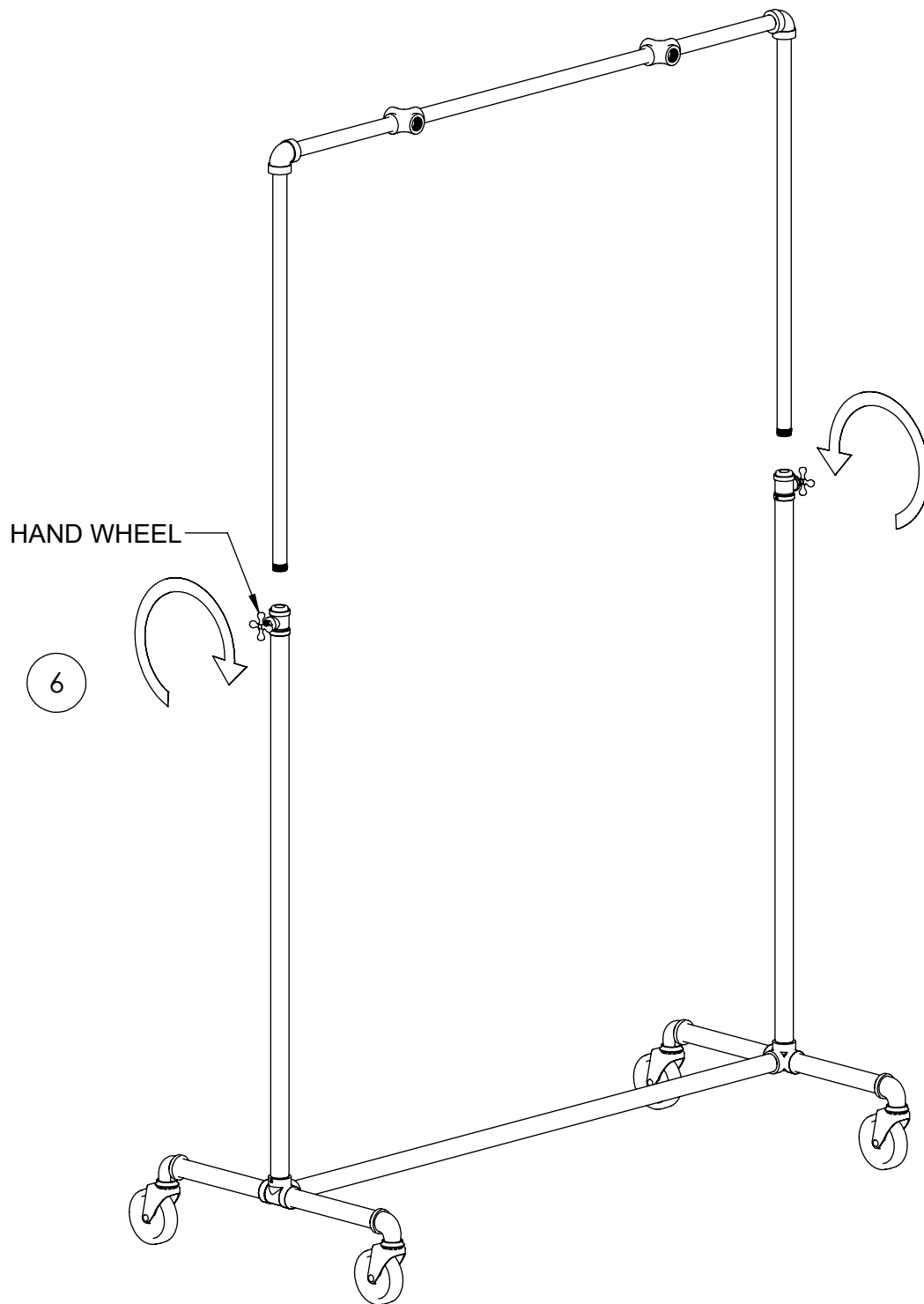

- 6 (UNTIGHTEN HAND WHEEL)
DROP HANGBAR ASSEMBLY FROM STEP 7 AS SHOWN AT DESIRED HEIGHT
& LOCK IN POSITION BY TIGHTENING THE HAND WHEEL.

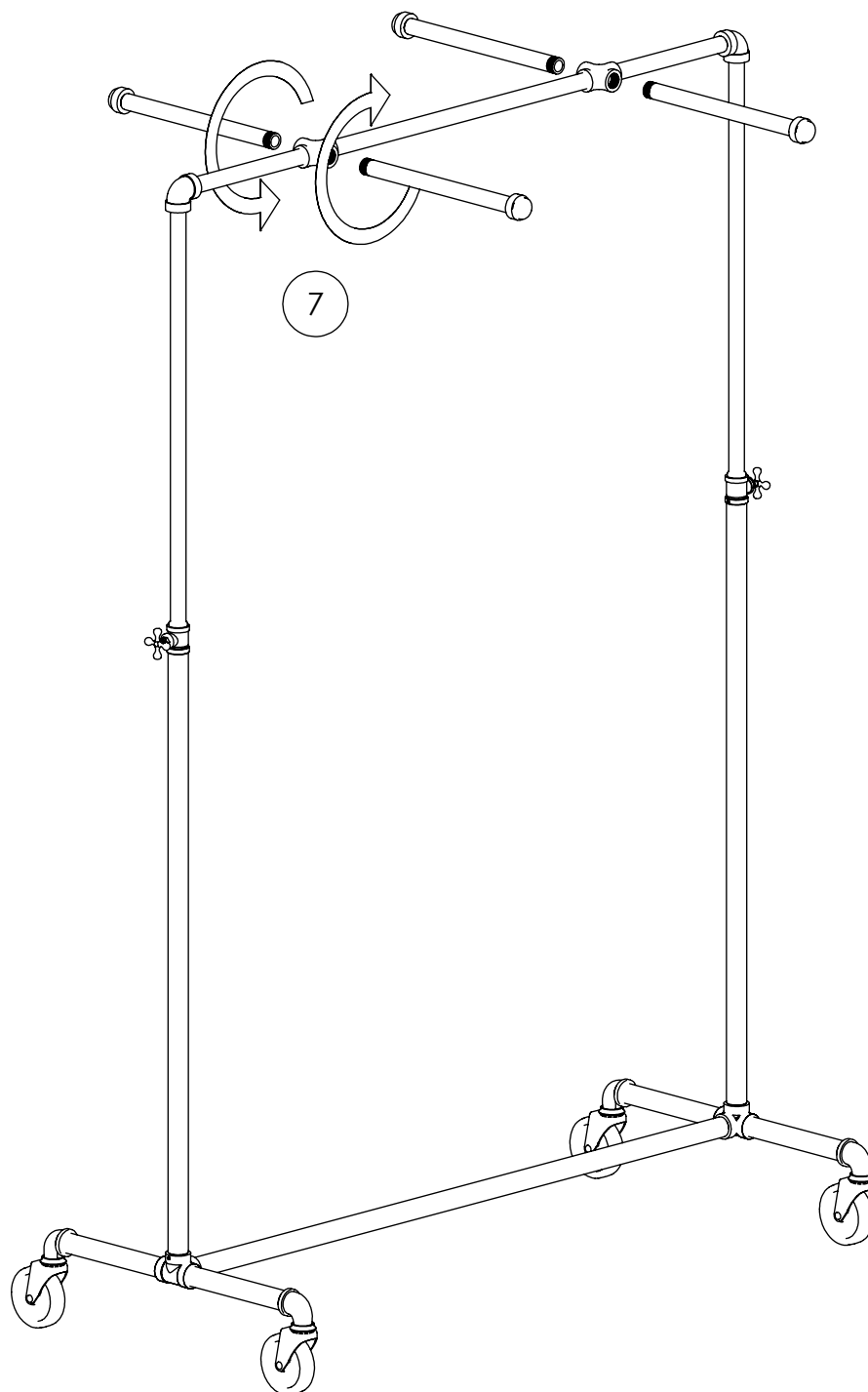

7

BY HAND, SCREW IN FACEOUTS TO HANGBAR.